



IntelliTrak™
Material Handling Solutions

1500 / 3500 SERIES

Heavy-Duty Overhead Conveyor
40,000⁺ lb. Load Capacity



HEAVY-DUTY 1500 / 3500 SERIES

IntelliTrak™
Material Handling Solutions

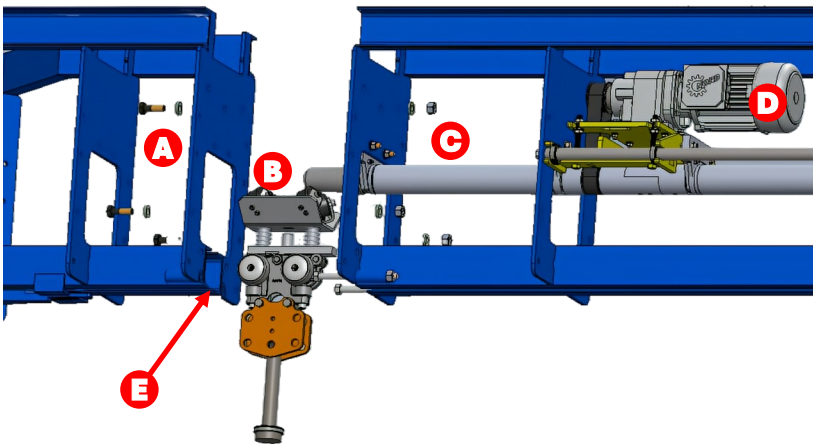

Close-up of the Heavy-Duty Series Friction Drive Overhead Conveyor with Rotating-Tube

- A** Profile Sections are bolted for greater flexibility.
- B** Trolley Drivehead is spring-loaded to the drive tube.
- C** Drive Tube rotates, moving the trolley assembly.
- D** Motor Assembly powers the drive tube.
- E** 4" - 6" Channel for 40,000+ lb. loads.

BENEFITS OF AN INTELLITRAK SYSTEM

LESS DOWNTIME REQUIRED FOR INSTALLATION, MODIFICATIONS AND MAINTENANCE.

A modular support structure (with bolted profile sections) means the system can continue to operate during maintenance and modifications.

LESS FLOORSPACE REQUIRED

Forward and Reverse, VDLs, shuttles, and deadheads minimize system footprint.

CLEANER AND QUIETER DRIVE SYSTEM

A rotating-tube friction drive (no chain) means a cleaner finished product and quieter operation.

MINIMAL MAINTENANCE, MORE RELIABLE SYSTEM

A friction drive with no chains means less technical labor and wear parts, resulting in a more reliable system with less downtime.

INCREASED EFFICIENCY WITH INDEPENDENTLY-CONTROLLED ZONES

- Forward and Reverse in same system.
- Stop one carrier without stopping the entire system.
- Change processes or destinations of products on the fly.
- Utilize shuttles to move products more efficiently.
- Energy efficient: zones run only when needed.

INLINE SPEED CHANGES

Sections of the system can be configured to run at different speeds using different ratio gear motors and variable frequency drives.

SYSTEM OPTIONS

Vertical Drop Lift
for vertical
transport



Shuttle for
horizontal
transport

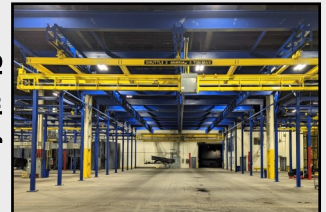

Custom-designed
carrier and/or
load bar



Switches to
change path
of trolley

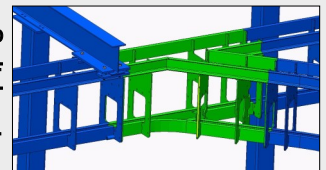

Curves-
driven and
non-driven

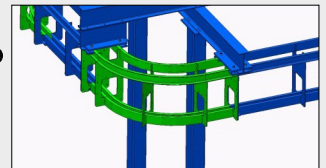

Deadheads
reduce need for
large turns

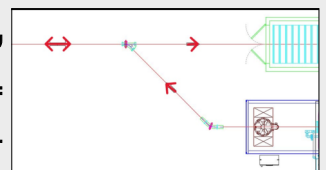

*Forward/Reverse on
the same line*

To see the Heavy-Duty Series in action visit www.intellitrak.com.

For a custom quote, call 513-714-4133 x2